

WEIGHT 1.333 lbm
MATERIAL 316L SS

REVISION HISTORY				
ZONE	REV	DESCRIPTION	DATE	APPROVED
	1	INITIAL	11/24/2020	CLR
B-3	2	ADDED SURFACE ROUGHNESS NOTE	11/28/2020	CLR
B-4	3	MODIFIED 1/4" HOLE DESCRIPTION	11/28/2020	CLR

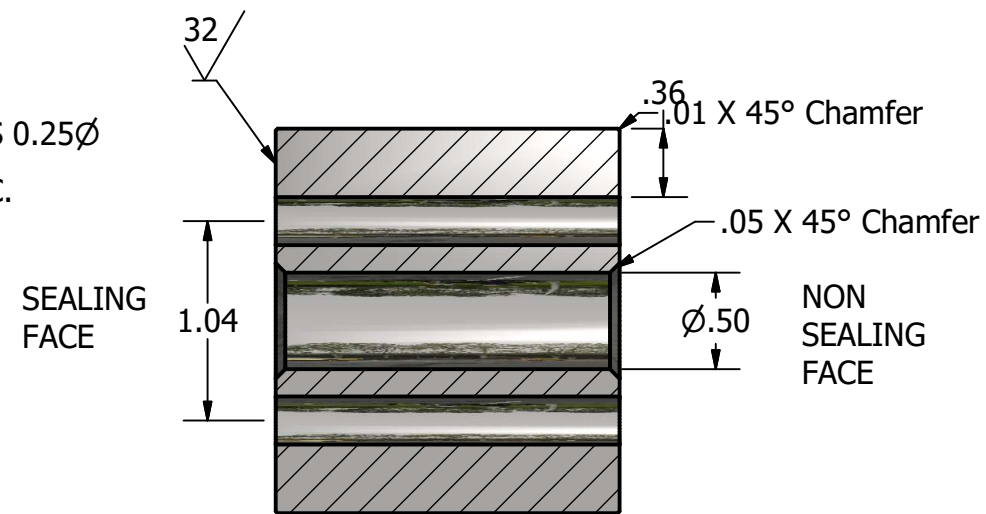

SECTION A-A
SCALE 1 : 1

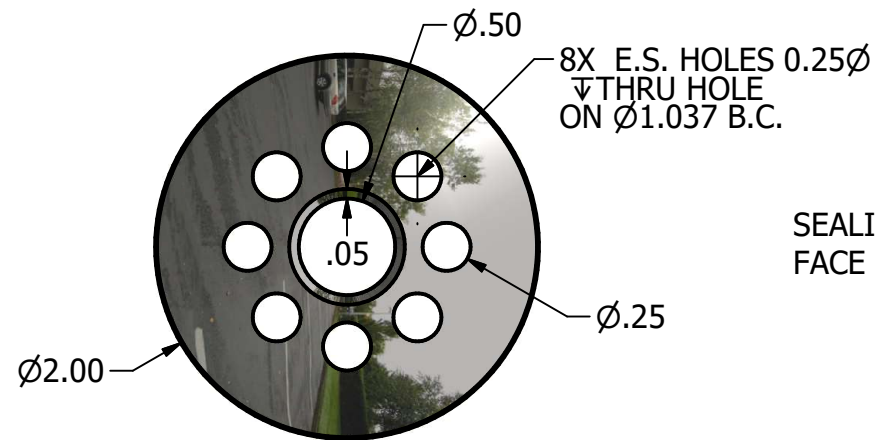
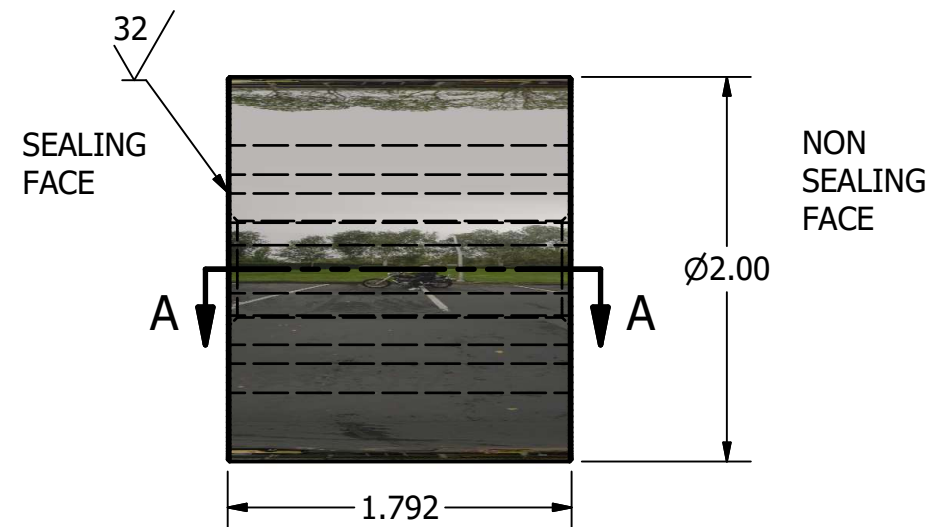

NOTES:

- 1) OP PENETRATOR SHOULD BE WELDED IN HATCH SHELL
- 2) SURFACE ROUGHNESS VALVE NO TO EXCEED 32 MICRO-INCES (32 RMS) ON THE SEALING SURFACES.

PARTS LIST			
ITEM	QTY	PART NUMBER	DESCRIPTION
1	1	OP-02	OP Penetrator - 316L SS

OP VALVE WAS DESIGNED AND FABRICATED
BY ALEC SYMTH

ALEC SYMTH
1141 Custis Street
Alexandria VA 22308

DRAWN AS	11/24/2020	ALEC SYMTH			
CHECKED CLR	11/24/2020				
QA		TITLE			
MFG AS	11/24/2020	OP Penetrator			
APPROVED AS	11/24/2020				
		SIZE B		DWG NO OP-02	REV 1
		SCALE			SHEET 1 OF 1